

Site identification Home Inspection
 Property Owner Clear Lake Camp Well Number 1
 Address 115293 Bradford Ave Clear Lake Ia
 Tenant Housing
 Well Depth 130 ft Date completed 4/23/00

Drill method rotary auger cable other _____
Hole size
12 1/4 inch from 0 ft to 116 ft
7 1/2 inch from 114 ft to 130 ft

Location County Cerro Gordo
3/4 mi. ^N and 1 mi. ^E of intersection of 514 and D35
1/4 of the SE 1/4 of the 22 TWP 96 RNG 22 ^E

Record all depth measurements from ground level (GL). Use (+) for above GL measurements.
Casing Drive shoe (yes) (no) Pitless adapter (yes) (no)
 Size (D/OD) Type / Wt Depth top Depth bottom Amount (length)
8" PVC 200 +1 1/2 115 116 1/2

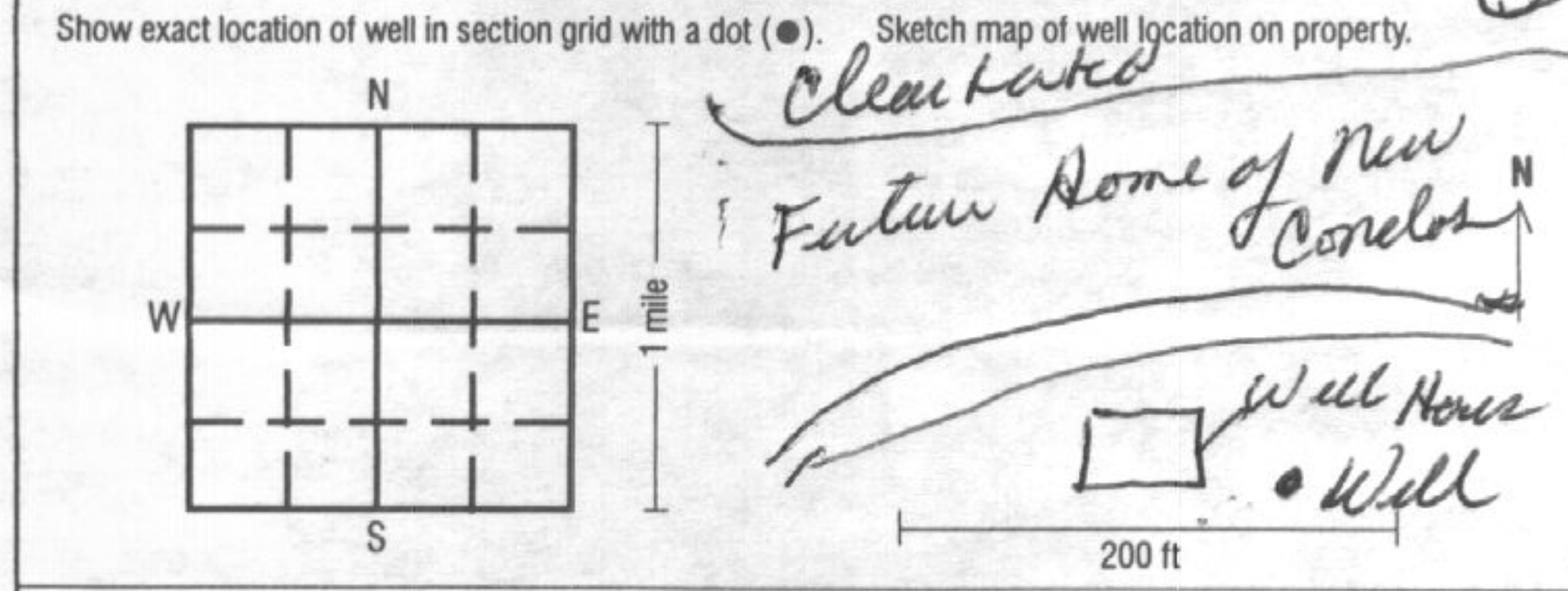

Perforated or slotted casing? (yes/no)
 Perforated / slotted from _____ ft to _____ ft
 Perforated / slotted from _____ ft to _____ ft

upland hillside valley Elevation (if known) _____

Casing grouted? (yes) (no) Placement method Pump in
 Type Depth Top Depth bottom Amount (vol/wt)
Ben soil 5 114 300 gal

Formation log

From	To	Color	Hardness	Formation description
0	2			Top soil
2	20	yel		Clay
20	60	Gray		shale
60	75	Yk		"
75	113	Blu		"
113	122	Bran mar		Dundstone
122	126	yellow		shale
126	127	Gray		shale
127	130	Gray		Lemiston

Well screen? (yes/no)
 Diameter Slot size Depth Top Depth Bottom Length Material
 0.____
 0.____

Bottom capped (yes/no) with _____
 Seals / Packers (yes/no) kind _____ depth _____ ft
 Gravel packed (yes/no) from _____ ft to _____ ft
 type _____ amount _____

Well developed? (yes/no)
 Explain air compressor
 (pumped, airlifted, bailed) for 2 hrs at 150 GPM.

Pump installed? (yes/no) Date 5/10/00
 Installer's name Lake Mills Pump
 Type of pump Sub Depth to intake _____ ft
 Pump diameter _____ Rated capacity _____ GPM

Water information Aquifer: sand / gravel limestone sandstone
 Main water-supply zone from 113 ft to 122 ft seepage well
 Static water level 50 ft (below above) GL; tape airline E-line estimate
 Pumping water level 100 ft below GL; tape airline E-line estimate
 At yield of 150 GPM; orifice volumetric estimate
 Measurements taken at 11:35 (AM/PM) Date 3/23/00

Remarks (including depth of lost drilling fluids, materials, or tools)

Water quality test? (yes/no) Date tested ____/____/____
 Tested by _____

Well use
 Domestic Municipal Commercial
 Livestock Public supply Monitoring
 Test well Irrigation Other _____ (explain)

Contractor Bill Beemer Well Co
 Address 2015 Fenton Ave Webster City Ia
 Driller Patt Estlund Certification no. 40055