

Site identification
 Property Owner City of Wall Lake Well Number _____
 Address Wall Lake, Iowa
 Tenant _____
 Well Depth 43 ft Date Completed 6 / 26 / 2000

Location County Sac County
 _____ mi. ^N and 2 1/2 mi. ^E of intersection of East 1st St and Hwy 36
Blacks W
NE 1/4 of the SW 1/4 of the SW 1/4 of Sec 7 TWP 86 RNG 36 E
Viola Twp W

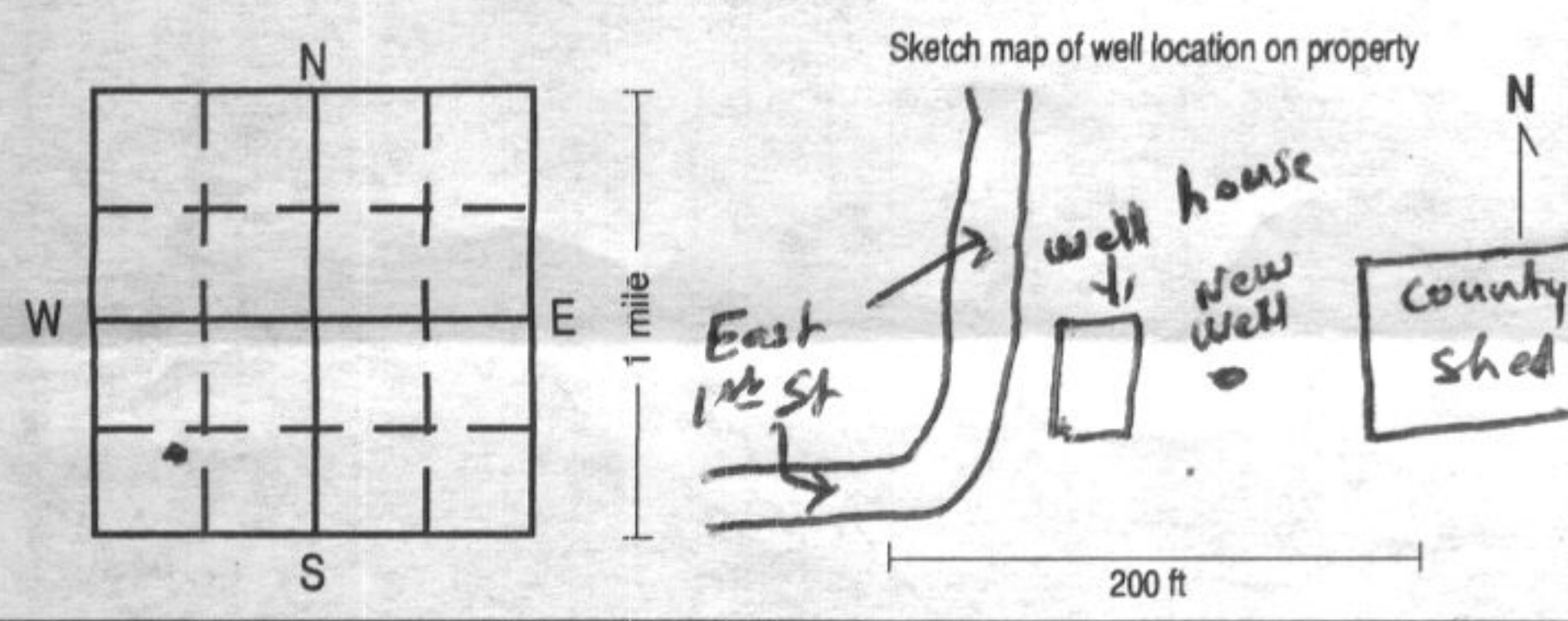

upland hillside valley Elevation (if known) _____

Formation log

From	To	Color	Hardness	Formation description
0	4	Black		fiu
4	7	Brown		slay silt
7	11	Black		silt
11	15	Blue		clay
15	18 1/2	Blue		gravelly clay
18 1/2	43	Blue		Sand + gravel
43	46	Blue		Very Coarse dirty gravel

Remarks (including depth of lost drilling fluids, materials, or tools)

Well use

Domestic Municipal Industrial
 Livestock Public Supply Monitoring
 Test Well Irrigation Other _____ (explain)

Drill method rotary auger cable other _____
Hole size
~~12~~ inch from 0 ft to _____ ft
30 inch from 0 ft to 46 ft

Record all depth measurements from ground level (GL). Use (+) for above GL measurements.

Casing Drive shoe (yes/no) Pitless adaptor (yes/no)

Size (ID/OD)	Type/Wt	Depth top	Depth bottom	Amount (length)
12"	Steel	+ 4'	33	37'
(top 8' is pitless unit)				

Perforated or slotted casing? (yes/no)

Perforated / slotted from _____ ft to _____ ft
 Perforated / slotted from _____ ft to _____ ft

Casing grouted? (yes/no)

Type	Depth Top	Depth Bottom	Amount
Neat Cement	6 1/2	10	2/3 cu yd
bentonite	10	13	12 bags

Well screen? (yes/no)

Diameter	Slot size	Depth Top	Depth Bottom	Length	Material
12"	.100	33	43	10'	Stainless Steel

Bottom capped (yes/no) with Stainless Steel plate
 Seals / Packers (yes/no) kind _____ depth _____ ft
 Gravel packed (yes/no) from 13' ft to 44 1/2' ft
 type pea rock amount 8 Tons

Well developed? (yes/no)
 Explain Surge block + pumped

Pump installed? (yes/no) Date _____ / _____ / _____
 Installer's name _____
 Type of pump _____ Depth to intake _____ ft
 Pump diameter _____ Rated capacity _____ GPM

Water information Aquifer: sand/gravel limestone sandstone
 Main water-supply zone from 30 ft to 43 ft
 Final water level (static water level) 11 ft (below / above) GL.
 Pumping water level 20-5 ft below GL; tape airline E-line
 At yield of 590 GPM; orifice volumetric estimate Date 6/24/2000

Water quality test? (yes/no) Date tested _____ / _____ / _____
 Tested by _____
 Test results _____

Contractor Alton Well & Concrete Co Inc
Address P.O. Box F, Alton, Ia. 51003
Driller Larry Vande Brake Certification no. 40074