

67515

WELL RECORD

PWTS Permit No. 30569

Iowa Department of Natural Resources - Geological Survey  
109 Trowbridge Hall, Iowa City, IA 52242-1319 PH (319) 335-1575

PWTS Well No. 2142360

County Permit No. \_\_\_\_\_

Site identification 209 GREEN LN CENTER  
Property Owner SOLSMAN BROS Other ID \_\_\_\_\_  
Address 504 MAIN ST. HOSPERIA IA  
Tenant \_\_\_\_\_  
Well Depth 36 ft Date completed 6/18/09

Drill method  rotary  auger  cable other BUCKETING  
Hole size  
30 inch from 0 ft to 36 ft  
hole size continued  
\_\_\_\_\_ inch from \_\_\_\_\_ ft to \_\_\_\_\_ ft

Location County CLAY  
\_\_\_\_\_ mi. N and \_\_\_\_\_ mi. E of intersection of 10 AVE E and MILWAUKEE EAST  
NW 1/4 of the SE 1/4 of the NW 1/4 of Sec. 8 TWP 96 RNG 36 E

Record all depth measurements from ground level (GL). Use (+) for above GL measurements.  
Casing Drive shoe (yes/no) Pitless adapter (yes/no)  
Size (ID/OD) Type / WT Depth top Depth bottom Amount (length)  
15 SEC 40 0 15 15'

GPS Coordinates (NAD83 datum only) decimal degrees:  
43.1459999 N. Latitude -95.124397 W. Longitude.

Perforated or slotted casing? (yes/no) (no)  
Perforated / slotted from 15 ft to 36 ft  
Perforated / slotted from \_\_\_\_\_ ft to \_\_\_\_\_ ft

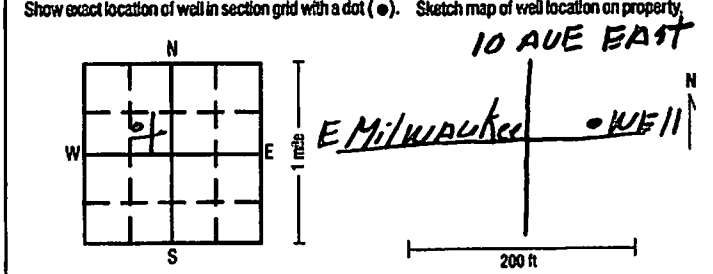

Casing grouted? (yes/no) (no) Placement method \_\_\_\_\_  
Type Depth top Depth bottom Amount (vol/wt)

upland  hillside  valley  level surface Elevation (if known) \_\_\_\_\_

Well screen? (yes/no) \_\_\_\_\_  
Diameter Slot size Depth top Depth bottom Length Material

Formation log

From	To	Color	Hardness	Formation description
0	5			SANDY CLAY
5	16			Med. Sand
16	23			COARSE S+G
23	25			CLAY lenses
25	36			COARSE S+G

Bottom capped (yes/no) (no) with SEC. 40 PUG CAP.  
Seals / Packers (yes/no) (no) kind \_\_\_\_\_ depth \_\_\_\_\_ ft  
Gravel packed (yes/no) from 4 ft to 36 ft  
type PEA amount 15 Ton

Well developed? (yes/no) (yes)  
Explain pumped  
(pumped, airlifted, bailed) for 1 hrs at 500 GPM

Pump installed? (yes/no) (yes) Date \_\_\_\_\_ / \_\_\_\_\_ / \_\_\_\_\_  
Installer's name GRIFFIN DEWATERING  
Type of pump Submersible Depth to intake 34 ft  
Pump diameter 4" Rated capacity 500 GPM

Water information Aquifer:  sand / gravel  limestone  sandstone  
Main water-supply zone from 10 ft to 36 ft  seepage well  
Static water level 10 ft (below / above) GL;  tape  airline  E-line  estimate  
Pumping water level 30 ft below GL;  tape  airline  E-line  estimate  
At yield of 500 GPM;  orifice  volumetric  estimate for 1 hours  
Measurements taken at 10:30 (AM / PM) Date 6/18/09

Remarks (including depth of lost drilling fluids, materials, or tools)

Water quality test? (yes/no) (no) Date tested \_\_\_\_\_ / \_\_\_\_\_ / \_\_\_\_\_  
Tested by \_\_\_\_\_

Well use  
 Domestic  Heat pump  Commercial  
 Livestock  Municipal  Monitoring  
 Test well  Public supply  Other TEMP. DEWATERING  
 Irrigation

Contractor GRIFFIN DEWATERING  
Address 6414 S. 84th Omaha NE  
Driller David Lane Certification no. 3600