

54830

WELL RECORD

54830

Iowa Department of Natural Resources Geological Survey Bureau  
109 Trowbridge Hall Iowa City, Ia. 52242-1319 PH (319) 335-1575

Permit No. \_\_\_\_\_

**Site identification**  
 Property Owner Humboldt County Well Number #1  
 Address Rutland Marsh  
 Tenant \_\_\_\_\_  
 Well Depth 280 ft Date Completed 1 / 18 / 2002

**Drill method**  rotary  auger  cable other \_\_\_\_\_  
**Hole size**  
10 inch from 0 ft to 43 ft hole size continued \_\_\_\_\_ inch from \_\_\_\_\_ ft to \_\_\_\_\_ ft  
8 inch from 43 ft to 400 ft \_\_\_\_\_ inch from \_\_\_\_\_ ft to \_\_\_\_\_ ft  
 Record all depth measurements from ground level (GL). Use (+) for above GL measurements.

**Location** County Humboldt  
 \_\_\_\_\_ mi. N and 0.5 mi. E of intersection of 200th and Kentucky Ave.  
SE 1/4 of the SE 1/4 of the SW 1/4 of Sec 22 TWP 92 RNG 29 E W

**Casing** Drive shoe (yes / no) Pitless adaptor (yes / no)

Size (ID/OD)	Type / Wt	Depth top	Depth bottom	Amount (length)
<u>4"</u>	<u>Sch 80 PVC</u>	<u>+2.5</u>	<u>240</u>	<u>242.5</u>

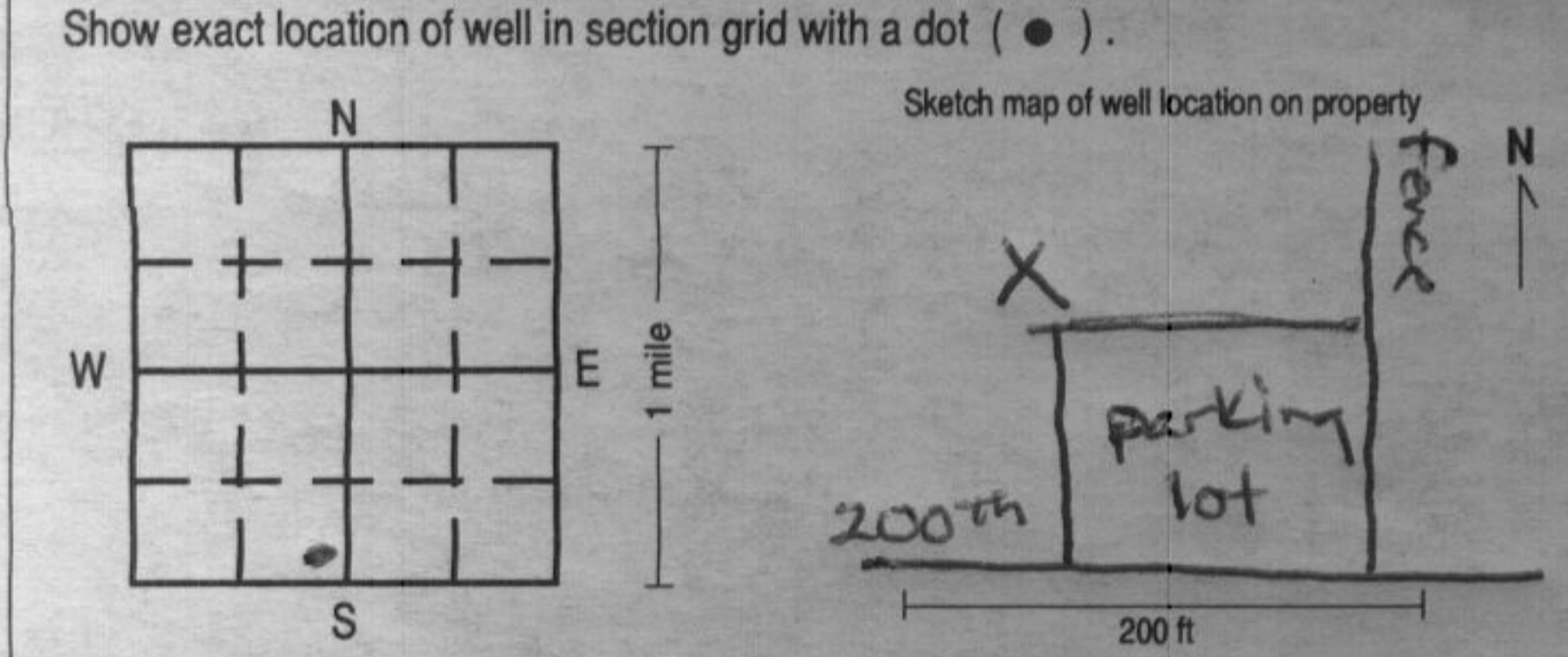

**Perforated or slotted casing?** (yes / no)  
 Perforated / slotted from \_\_\_\_\_ ft to \_\_\_\_\_ ft  
 Perforated / slotted from \_\_\_\_\_ ft to \_\_\_\_\_ ft

**Casing grouted?** (yes / no)

Type	Depth Top	Depth Bottom	Amount
<u>Benseal</u>	<u>0</u>	<u>234</u>	
<u>Holeplug</u>	<u>280</u>	<u>400</u>	

upland  hillside  valley Elevation (if known) \_\_\_\_\_

**Well screen?** (yes / no)

Diameter	Slot size	Depth Top	Depth Bottom	Length	Material
<u>4"</u>	<u>.010</u>	<u>240</u>	<u>280</u>	<u>40'</u>	<u>Sch 80 PVC</u>

**Formation log**

From	To	Color	Hardness	Formation description
<u>0</u>	<u>3</u>	<u>Black</u>	<u>-</u>	<u>Topsoil</u>
<u>3</u>	<u>22</u>	<u>lt. Brown</u>	<u>-</u>	<u>Silty sandy clay</u>
<u>22</u>	<u>43</u>	<u>Dk. Gray</u>	<u>-</u>	<u>Sandy lean clay (Till)</u>
<u>43</u>	<u>60</u>	<u>Tan</u>	<u>Med</u>	<u>Limestone</u>
<u>60</u>	<u>400</u>	<u>Gray tan</u>	<u>Hard</u>	<u>Limestone</u>

Bottom capped (yes / no) with threaded PVC plug  
 Seals / Packers (yes / no) kind \_\_\_\_\_ depth \_\_\_\_\_ ft  
 Gravel packed (yes / no) from 234 ft to 280 ft  
 type \_\_\_\_\_ amount \_\_\_\_\_

**Well developed?** (yes / no)  
 Explain Air lifted

**Pump installed?** (yes / no) Date \_\_\_\_\_ / \_\_\_\_\_ / \_\_\_\_\_  
 Installer's name \_\_\_\_\_  
 Type of pump \_\_\_\_\_ Depth to intake \_\_\_\_\_ ft  
 Pump diameter \_\_\_\_\_ Rated capacity \_\_\_\_\_ GPM

**Water information** Aquifer:  sand/gravel  limestone  sandstone  
 Main water-supply zone from 240 ft to 280 ft  
 Final water level (static water level) 43 ft (below / above) GL.  
 Pumping water level \_\_\_\_\_ ft below GL;  tape  airline  E-line  
 At yield of \_\_\_\_\_ GPM;  orifice  volumetric  estimate Date \_\_\_\_\_

**Water quality test?** (yes / no) Date tested \_\_\_\_\_ / \_\_\_\_\_ / \_\_\_\_\_  
 Tested by \_\_\_\_\_  
 Test results \_\_\_\_\_

**Remarks** (including depth of lost drilling fluids, materials, or tools)

**Well use**  
 Domestic  Municipal  Industrial  
 Livestock  Public Supply  Monitoring  
 Test Well  Irrigation  Other \_\_\_\_\_ (explain)

Contractor AQUADRILL, INC.  
 Address 717 E 2nd Ave., Coralville IA  
 Driller Matthew J. White Certification no. 40029